

Apollo 2 Series Tunnel Light



Description

Apollo 2 Series is an extensible modular conceptual LED Tunnel Light, with its optional aluminum or plastic housing, the selectable 16 or 40 pcs LED module makes this luminaire's power and/or lumens very flexible for your various demands.

The pre-reserved NEMA socket for photocell makes future smart control and smart city ready, and the easy versatile mounting make it available for the tunnel, underpass and passage and more applications.

IP 66 Working Temp: -40°C~55°C Working Humidity: ≤95%

Light Sources & Optics

Light Source: Lumileds
 Color Temperature: 4,000K (Options: 3,000K and 5,000K)
 Color Rendering Index: Ra>70
 L80 Lifetime @ 85°C: 55,000 hours
 Optic Lens: Polycarbonate

Electronics

Input Voltage: 120-277Vac,50/60Hz; 220-240Vac,50/60Hz
 Power Factor: >0.95
 Dimming: Non-dimming / 1-10V
 Surge Protection: (Driver built-in 10KV protection. Or SPD 10KV/20KV is optional)

Dimensional Drawings

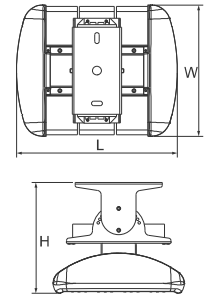

Ordering Information

Name	Model	Power (W)	Q'ty of Module	Flux (lm)	Dimension (mm)
Apollo 2 (Tunnel)	TL2K1080	80	2	11,200	L284×W301×H254
	TL2K1120	120	3	16,800	L369×W301×H254
	TL2K1160	160	4	22,400	L454×W301×H254
	TL2K1240	240	6	33,600	L624×W301×H254

Light Distribution Curves

